

K086MMHF-03-1

Connector 1

2.92mm Male Plug 40 GHz

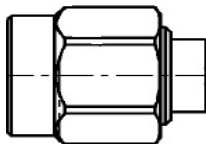

Connector 2

2.92mm Male Plug 40 GHz

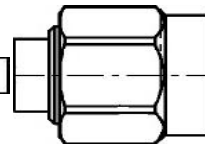

Length Dimensions inch/cm
Overall end-to-end: 3.22/8.18
Between Ref. Planes: 3/7.62
Less Connectors: 2.36/5.99
C1 Ref. Plane (R/P): 0.11/0.28
C2 Ref. Plane (R/P): 0.11/0.28

Cable Type: 0.086" Hand Formable, RoHS
Jacket: None
Length: 3 inches long between interfaces
Phase matching: Phase Matching <1ps of another
Test Data: N/A
Rotation: N/A

Cable Marker typically placed center cable includes P/N, Serial, and Manufacturer

These specifications are subject to change without notice.

Component images are not to scale.

SPECIFICATIONS:

FREQUENCY RANGE: DC to 40 GHZ

RETURN LOSS: >16dB

INSERTION LOSS (up to above frequency limit): <1.1 dB/ft @ 18 GHz, <1.4 dB/ft @ 27 GHz, <2.0 dB/ft @ 40 GHz, <2.4 dB/ft @ 67 GHz (typical), +0.3 dB per connector

CONNECTOR 1: 2.92mm M, direct solder, straight, Precision Connector Inc. P/N: 3146, or equivalent

CONNECTOR 2: 2.92mm M, direct solder, straight, Precision Connector Inc. P/N: 3146, or equivalent

CABLE TYPE: Hand-Formable (tin-dipped woven copper braid outer conductor), (magnetic steel wire center conductor), 0.086" (2.2mm) diameter nominal, Micro-Coax P/N: UT-85-Form (select 67 GHz stocks), or equivalent

MINIMUM INSIDE BEND RADIUS: 0.125" (3.2mm) installation, 0.375" (9.5mm) continuous flexing

SOLDER: 96.5Sn3.0Ag0.5Cu (SAC305) Pb-free, COMPLIANT WITH EU Directive RoHS 3 (2015/863)

RF COAX INC.

1725 San Felipe Road, Suite 3
Hollister, CA 95023 USA
TEL: 831-635-0820, FAX: 831-785-2990
sales@rfcoax.com www.rfcoax.com
All rights reserved
File No: 0.1/0.25,2.82/7.16,0.1/0.25

CAGE 1WF56

RF Cable Assembly, 2.92mm M to 2.92mm M, 0.086 hand-formable, 40 GHz, phase matched <1ps of another, 3-inches long between interfaces, RoHS

TYPE: Product Specification

REVISION: A **Date :** 07/20/2025

Item : K086MMHF-03-1